

THE CORPORATION OF THE TOWNSHIP OF CRAMAHE

BY-LAW NO. 2026-25

Being a By-law under the provisions of Section 34 of the Planning Act, R.S.O. 1990, to amend By-law No. 08-18, the Comprehensive Zoning By-Law of the Township of Cramahe.

WHEREAS the Council of the Township of Cramahe deems it advisable to amend By-law No. 08-18 with respect to the lands described in this By-Law; and

WHEREAS Council has conducted a public meeting as required by Section 34(12) of the *Planning Act*, R.S.O. 1990, as amended; and

WHEREAS the matters herein are in conformity with the provisions of the Official Plan of the Township of Cramahe, as amended; and

NOW THEREFORE the Council of the Corporation of the Township of Cramahe hereby enacts as follows:

1. **THAT** Map 5 of By-Law No. 08-18 is hereby amended by changing the zone category of certain lands located in Concession 2 Part of Lot 35 in the Township of Cramahe, as illustrated on Schedule 'A' to this By-Law, and
 - I. Lands to be rezoned from the Rural (RU) Zone to the Rural Residential (RR) Zone, and
 - II. Lands to be maintained as Environmental Conservation (EC)
2. **THAT** this By-Law shall become effective on the date it is passed by the Council of the Corporation of the Township of Cramahe, subject to the applicable provisions of the *Planning Act*, R.S.O. 1990, as amended.
3. **THAT** the Clerk is hereby authorized and directed to proceed with the giving of Notice under Section 34(18) of the *Planning Act*, R.S.O. 1990, as amended.

Read a first, second and third time and finally passed this 26th day of May 2026.



Mandy Martin, Mayor



Holly Grant, Clerk

Schedule "A" – By-law 2026-25

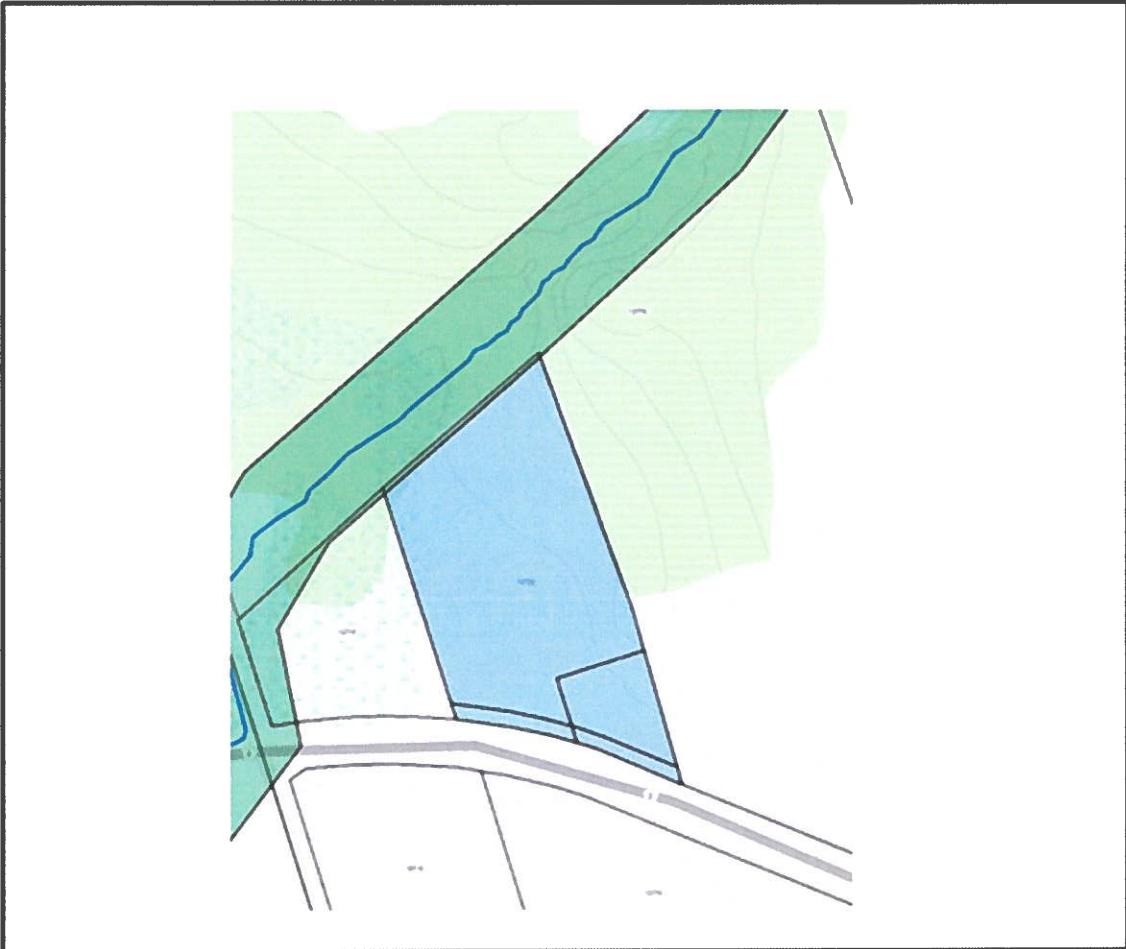

Lands to be rezoned from the Rural (RU) Zone to the Rural Residential (RR) Zone



Lands to be remain as Environmental Conservation (EC)

Schedule A to By-law No. 2026-25

Passed this 26th day of May 2026

Andy Hunter

Mayor

Heely

Clerk

Subject Property

Concession 2, Part Lot 35, Part 4 and 5, RP 39R10897

Township of Cramahe

File No. D14-HIC-01-26

